



Features

- Flush-mounted diaphragm of stainless steel, welded by laser
- Nominal pressure PN 600
- Clamping flange, adjustable
- Volume optimized diaphragm base
- Connection of measuring instrument:
 - directly welded
 - directly screwed
 - with capillary

Options

- Material certificate acc. to DIN EN 10204-3.1

Application area

- Food industry

Application

Suitable for mounting to bourdon tube pressure gauges and pressure transmitters. The diaphragm seal is used for high pressure applications and for highly viscous media.

Technical Data

Process connection

clamping flange adjustable
PN 600 bar

Diaphragm seal material

basic body:
st. steel mat. no. 1.4404 (316L)
measuring instrument connection and
clamping flange: st. steel

Separating diaphragm

material stainless steel,
standard material: st. steel mat.-no.
1.4435 (316L), further materials see order
code or upon request

Measuring instrument connection

· directly welded/screwed
· with capillary
see order code
material stainless steel

Process temperature

dependent on measuring system,
diaphragm seal filling liquid and instal-
lation.

Diaphragm seal filling liquid

see data sheet D5-003.
Standard according to order code

Installation instructions

see operating instructions BTA-062

Weights

with measuring instrument connection
G 1/2 approx. 1.1 kg

Special designs

available without clamping flange

Measuring instrument connection

connection G1/2
per DIN EN 834-1

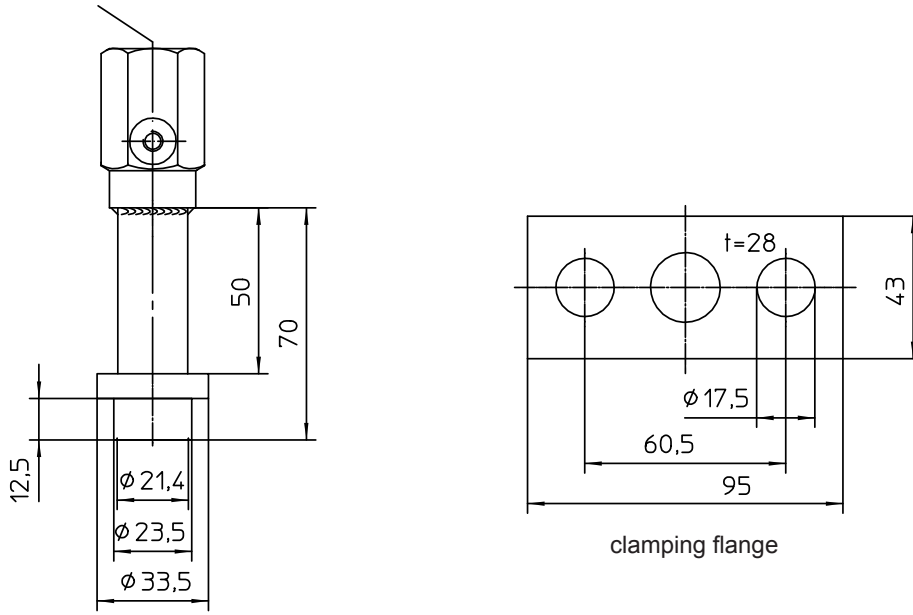

capillary length	
length m	order- code
1	11
1.6	12
2.5	13
4	14
5	21
6	15
7	23
8	16
10	17
others	9

Order Details - please give additional specifications for models not listed -

Diaphragm seal for food/pharmaceutical/biotechnology for homogenizers		DD8020	
wetted parts	· stainless steel mat.no. 1.4404/1.4435 (316 L), standard · variant	G1	G9
connection	· clamping flange, adjustable, material stainless steel · without clamping flange	K1	K2
connection of measuring instrument	· directly	· welded	A400
		· screwed G 1/2	A300
	· with capillary	· welded	B40 ..
		· screwed G 1/2	B20 ..
	· with capillary and stainless steel protective tube	· welded	B50 ..
		· screwed G 1/2	B10 ..
system filling ¹	<u>filling liquid</u>	<u>temperature range²</u>	
	· silicon oil FS 20, standard	-10...+140 °C	L20
	· silicon oil FS 20, high temp. range, max.	-40...+200 °C	L11
	· glycerine/water FGW	-20...+120 °C	L15

additional features (to be indicated in case of need, only)

material certificate acc. to DIN EN 10204- 3.1, wetted parts					W1020
order code (example):	DD8020	G1	K1	A400	L15

¹ Please check data sheet D5-003 for further information.
Please state temperature range to allow an accurate calculation of the system.
² max. temperature of liquid filling for abs. pressure > 1 bar